



## ZED EVG - Electronic Ballasts 115V AC for Standard and High Output Germicidal Lamps and Amalgam Lamps Lamp-Ballast Combinations

Instant, Rapid and Preheat Start Ballasts

lamp type	lamp operation	lamps per ballast	ballast model	ballast form	page no.
<b>G36T5</b>	rapid start	1	S-EVG30-50W/425mA -1	D	36
	rapid start	2	EVG2x[30-50W]/425mA -1	F	38
	instant start	1	S-EVG30-50W/425mA IS-1	D-IS	43
	instant start	2	EVG2x[30-50W]/425mA IS-1	F-IS	45
<b>G64T5</b>	rapid start	1	EVG50-70W/425mA -1	E	37
	rapid start	2	EVG2x[50-70W]/425mA -1	F	38
	instant start	1	EVG50-70W/425mA IS-1	E-IS	44
	instant start	2	EVG2x[50-70W]/425mA IS-1	F-IS	45
<b>GHO36T5</b>	rapid start	1	EVG65-80W/880mA -1	E	37
	rapid start	2	EVG2x[65-80W]/880mA -1	F	38
	instant start	1	EVG65-80W/880mA IS-1	E-IS	44
	instant start	2	EVG2x[65-80W]/880mA IS-1	F-IS	45
<b>GHO64T5</b>	rapid start	1	EVG150-200W/1A -1	E	37
	instant start	1	EVG150-200W/1A IS-1	E-IS	44
<b>GIA120</b>	rapid start	1	EVG100-150W/1,5A -1	E	37
<b>GIA200</b>	rapid start	1	EVG150-200W/1,5A -1	H	39
<b>GIA240</b>	rapid start	1	EVG240W/2A -1	H	39
<b>GPH287T5L</b>	rapid start	1	EVG11-20W/425mA -1	A	35
	instant start	1	EVG11-20W/425mA IS -1	A-IS	42
<b>GPH303T5L</b>	rapid start	1	EVG11-20W/425mA -1	A	35
	instant start	1	EVG11-20W/425mA IS -1	A-IS	42
<b>GPH436T5L</b>	rapid start	1	EVG11-20W/425mA -1	A	35
	instant start	1	EVG11-20W/425mA IS -1	A-IS	42
<b>GPH793T5</b>	rapid start	1	S-EVG30-50W/425mA -1	D	36
	rapid start	2	EVG2x[30-50W]/425mA -1	F	38
	instant start	1	S-EVG30-50W/425mA IS-1	D-IS	43
	instant start	2	EVG2x[30-50W]/425mA IS-1	F-IS	45
<b>GPH846T5HO (600mA)</b>	rapid start	1	EVG50-70W/600mA -1	E	37
	rapid start	2	EVG2x[50-70W]/600mA -1	F	38
	instant start	1	EVG50-70W/600mA IS-1	E-IS	44
	instant start	2	EVG2x[50-70W]/600mA IS-1	F-IS	45
<b>GPH846T5HO (800mA)</b>	rapid start	1	EVG65-80W/880mA -1	E	37
	rapid start	2	EVG2x[65-80W]/880mA -1	F	38
	instant start	1	EVG65-80W/880mA IS-1	E-IS	44
	instant start	2	EVG2x[65-80W]/880mA IS-1	F-IS	45
<b>GPH893T5HO (600mA)</b>	rapid start	1	EVG50-70W/600mA -1	E	37
	rapid start	2	EVG2x[50-70W]/600mA -1	F	38
	instant start	1	EVG50-70W/600mA IS-1	E-IS	44
	instant start	2	EVG2x[50-70W]/600mA IS-1	F-IS	45
<b>GPH893T5HO (800mA)</b>	rapid start	1	EVG65-80W/880mA -1	E	37
	rapid start	2	EVG2x[65-80W]/880mA -1	F	38
	instant start	1	EVG65-80W/880mA IS-1	E-IS	44
	instant start	2	EVG2x[65-80W]/880mA IS-1	F-IS	45
<b>LTC40T5</b>	rapid start	1	S-EVG30-50W/425mA -1	D	36
	rapid start	2	EVG2x[30-50W]/425mA -1	F	38
	instant start	1	S-EVG30-50W/425mA IS-1	D-IS	43
	instant start	2	EVG2x[30-50W]/425mA IS-1	F-IS	45
<b>LTC64T5</b>	rapid start	1	EVG50-70W/425mA -1	E	37
	rapid start	2	EVG2x[50-70W]/425mA -1	F	38
	instant start	1	EVG50-70W/425mA IS-1	E-IS	44
	instant start	2	EVG2x[50-70W]/425mA IS-1	F-IS	45
<b>LTC75T5</b>	rapid start	1	EVG65-80W/880mA -1	E	37
	rapid start	2	EVG2x[65-80W]/880mA -1	F	38
	instant start	1	EVG65-80W/880mA IS-1	E-IS	44
	instant start	2	EVG2x[65-80W]/880mA IS-1	F-IS	45
<b>LTC80T5</b>	rapid start	1	EVG65-80W/880mA -1	E	37
	rapid start	2	EVG2x[65-80W]/880mA -1	F	38
	instant start	1	EVG65-80W/880mA IS-1	E-IS	44
	instant start	2	EVG2x[65-80W]/880mA IS-1	F-IS	45



Ballasts for other lamp types are available on request. We can also adapt ballasts to other lamp specifications.



## ZED EVG - Electronic Ballasts 115V AC for Standard and High Output Germicidal Lamps and Amalgam Lamps Lamp-Ballast Combinations

Ballasts for one and two lamp operation

lamp type	lamp operation	lamps per ballast	ballast model	ballast form	page no.
<b>NNI 120/86</b>	rapid start	1	EVG100-150W/1,5A -1	E	37
	preheat start	1	EVG100-150W/1,5A -1 -PH	E-PH	40
<b>NNI 125/86</b>	preheat start	1	EVG100-150W/1,5A -1 -PH	E-PH	40
<b>NNI 200/107</b>	rapid start	1	EVG160-200W/2A -1	H	39
	preheat start	1	EVG160-200W/2A -1 -PH	H-PH	41
<b>NNI 201/107XL</b>	rapid start	1	EVG160-200W/2A -1	H	39
	preheat start	1	EVG160-200W/2A -1 -PH	H-PH	41
<b>NNI 300/147XL</b>	rapid start	1	EVG300W/2,1A -1	H	39
	preheat start	1	EVG300W/2,1A -1 -PH	H-PH	41
<b>NNI 60/25U</b>	rapid start	2	EVG2x[50-70W]/670mA -1	F	38
	rapid start	1	EVG50-70W/670mA -1	E	37
<b>NNI 80/36U</b>	rapid start	1	EVG100-150W/1,5A -1	E	37
	preheat start	1	EVG100-150W/1,5A -1 -PH	E-PH	40
<b>TUV16</b>	rapid start	1	EVG11-20W/425mA -1	A	35
	instant start	1	EVG11-20W/425mA IS -1	A-IS	42
<b>TUV115</b>	rapid start	1	EVG100-150W/1,5A -1	E	37
<b>TUV240XPT</b>	rapid start	1	EVG240W/2A -1	H	39
<b>TUV36HO</b>	rapid start	1	EVG65-80W/880mA -1	E	37
	rapid start	2	EVG2x[65-80W]/880mA -1	F	38
	instant start	1	EVG65-80W/880mA IS-1	E-IS	44
	instant start	2	EVG2x[65-80W]/880mA IS-1	F-IS	45
<b>TUV36T5</b>	rapid start	1	S-EVG30-50W/425mA -1	D	36
	rapid start	2	EVG2x[30-50W]/425mA -1	F	38
	instant start	1	S-EVG30-50W/425mA IS-1	D-IS	43
	instant start	2	EVG2x[30-50W]/425mA IS-1	F-IS	45
<b>TUV64T5</b>	rapid start	1	EVG50-70W/425mA -1	E	37
	rapid start	2	EVG2x[50-70W]/425mA -1	F	38
	instant start	1	EVG50-70W/425mA IS-1	E-IS	44
	instant start	2	EVG2x[50-70W]/425mA IS-1	F-IS	45
<b>TUV75</b>	rapid start	1	EVG65-80W/880mA -1	E	37
	rapid start	2	EVG2x[65-80W]/880mA -1	F	38
<b>UNI 120</b>	rapid start	1	EVG100-150W/1,5A -1	E	37
<b>UNI 200</b>	rapid start	1	EVG160-200W/2A -1	H	39
<b>UNI 201</b>	rapid start	1	EVG150-200W/1,5A -1	H	39
<b>UNI 260</b>	rapid start	1	EVG240W/2A -1	H	39



Ballasts for other lamp types are available on request. We can also adapt ballasts to other lamp specifications.

# ZED EVG - Electronic Ballasts 115V AC for Standard and High Output Germicidal Lamps and Amalgam Lamps Rapid Start

*small but powerful:*  
*quick lamp start - space saving*



ballast form A

**Features**

- ⇒ electronic ballast for one-lamp operation
- ⇒ to be used with four-wire lamps
- ⇒ rapid start  
for applications with less than one switch-on cycle per day  
(otherwise preheat start ballasts are recommended)
- ⇒ equipped with active power factor correction
- ⇒ lamp status indication via LED indicators
  - green LED: lamp on
  - red LED: lamp fault
- ⇒ lamp status forwarding
  - photocoupler for lamp on / lamp fault

ballast name	input power [W]	input current [A]	power per lamp [W]	lamp current [A]	lamp type
EVG11-20W/425mA -1	up to 24	0,11 - 0,23	11-20	0,425 ± 10%	TUV16, GPH287T5L, GPH303T5L, GPH436T5L

<b>mains voltage:</b>	115V AC ± 10%
<b>mains frequency:</b>	45...65Hz
<b>efficiency:</b>	approx. 80%
<b>t<sub>c</sub>-temperature:</b>	max. 50°C
<b>ambient temperature:</b>	0...40°C
<b>status indication:</b>	operating status indicated - by LED: green = lamp on   red = lamp fault - by photocoupler (refer to 'Ballast Generals' for more information on lamp status indication via photocoupler)
<b>connection specifics:</b>	terminals 1...4, max. off-load voltage: 1.5kV <sub>pp</sub> photocoupler, max. current on OG: 5mA (open collector V <sub>OG1/0</sub> < 1V ⇒ V <sub>CESAT</sub> < 1V) max. cable length between ballast and lamp: 0,5m
<b>IP code:</b>	IP20
<b>mounting restrictions:</b>	upright, mains connector at bottom side, see 'Ballast Generals' for details
<b>wire gauge:</b>	0,5...1mm <sup>2</sup> ; strip length: 8mm

**Dimensions**

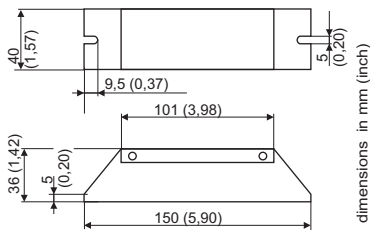

**Wiring diagram**

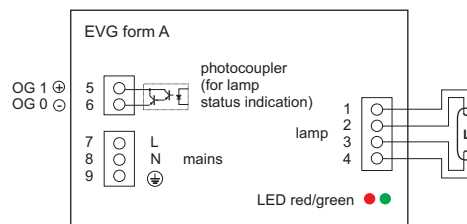



## ZED EVG - Electronic Ballasts 115V AC for Standard and High Output Germicidal Lamps and Amalgam Lamps Rapid Start

*small and smart:*

**quick lamp start - easy handling**



ballast form D

### Features

- ⇒ electronic ballast for one-lamp operation
- ⇒ to be used with four-wire lamps
- ⇒ rapid start  
for applications with less than one switch-on cycle per day  
(otherwise preheat start ballasts are recommended)
- ⇒ equipped with active power factor correction
- ⇒ lamp status indication via LED indicators
  - green LED: lamp on
  - red LED: lamp fault
- ⇒ lamp status forwarding
  - potential free relay contacts for lamp on / lamp fault

ballast name	input power [W]	input current [A]	power per lamp [W]	lamp current [A]	lamp type
S-EVG30-50W/425mA -1	32 - 55	0,25 - 0,53	30 - 50	0,39 - 0,42	G36T5, GPH793T5, LTC40T5, TUV36T5

<b>mains voltage:</b>	115V AC $\pm$ 10%
<b>mains frequency:</b>	45...65Hz
<b>efficiency:</b>	> 88%
<b>t<sub>c</sub>-temperature:</b>	max. 50°C
<b>ambient temperature:</b>	0...40°C
<b>relay contacts:</b>	potential free, load: 50...500mA at 24...230V AC; 50...500mA at 5...60V DC
<b>status indication:</b>	operating status indicated - by LED: green = lamp on   red = lamp fault - by relay (refer to 'Ballast Generals' for more information on lamp status indication via relay)
<b>IP code:</b>	IP20
<b>mounting restrictions:</b>	upright, mains connector at bottom side, see 'Ballast Generals' for details
<b>wire gauge:</b>	0,5...1mm <sup>2</sup> ; strip length: 8mm

### Dimensions

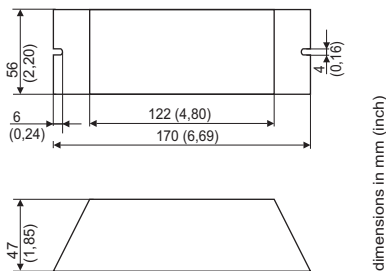

### Wiring diagram

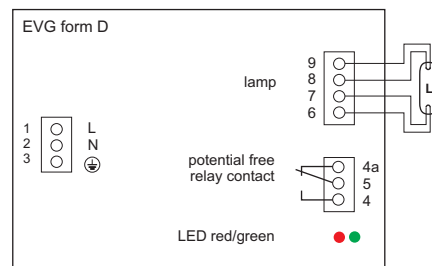



# ZED EVG - Electronic Ballasts 115V AC for Standard and High Output Germicidal Lamps and Amalgam Lamps Rapid Start

*established and proven:*  
**quick lamp start - easy handling**



ballast form E

**Features**

- ⇒ electronic ballast for one-lamp operation
- ⇒ to be used with four-wire lamps
- ⇒ rapid start  
for applications with less than one switch-on cycle per day  
(otherwise preheat start ballasts are recommended)
- ⇒ equipped with active power factor correction
- ⇒ lamp status indication via LED indicators
  - green LED: lamp on
  - red LED: lamp fault
- ⇒ lamp status forwarding
  - potential free relay contacts for lamp on / lamp fault

ballast name	input power [W]	input current [A]	power per lamp [W]	lamp current [A]	lamp type
EVG50-70W/425mA -1	55 – 75	0,43 - 0,72	50 - 70	0,39 - 0,42	G64T5, LTC64T5, TUV64T5
EVG50-70W/600mA -1	55 – 75	0,43 - 0,72	50 – 70	0,59 - 0,61	GPH846T5HO(600mA), GPH893T5HO(600mA)
EVG50-70W/670mA -1	55 – 75	0,43 - 0,72	50 – 70	0,65 – 0,7	NNI60/25U
EVG65-80W/880mA -1	70 – 85	0,55 - 0,8	65 – 80	0,85 – 0,9	GHO36T5, GPH846T5HO(800mA), GPH893T5HO(800mA), LTC75T8, LTC80T5, TUV36HO, TUV75
EVG150-200W/1A -1	160 – 220	1,26 - 2,1	150	0,8 - 1	GHO64T5
EVG100-150W/1,5A -1	110 - 160	0,86 - 1,55	100 - 150	1,4 - 1,5	LTC115T8, NNI80/36U, NNI120/86, UNI120, GIA120, TUV115

<b>mains voltage:</b>	115V AC ± 10%
<b>mains frequency:</b>	45...65Hz
<b>efficiency:</b>	> 88%
<b>t<sub>c</sub>-temperature:</b>	max. 50°C
<b>ambient temperature:</b>	0...40°C
<b>relay contacts:</b>	potential free, load: 50...500mA at 24...230V AC; 50...500mA at 5...60V DC
<b>status indication:</b>	operating status indicated - by LED: green = lamp on   red = lamp fault - by relay (refer to 'Ballast Generals' for more information on lamp status indication via relay)
<b>IP code:</b>	IP20
<b>mounting restrictions:</b>	upright, mains connector at bottom side, see 'Ballast Generals' for details
<b>wire gauge:</b>	0,75...1,5mm <sup>2</sup> ; strip length: 10...12mm

**Dimensions**

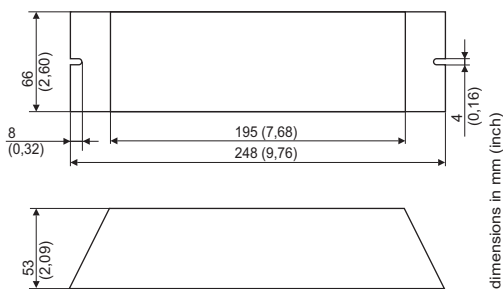

**Wiring diagram**

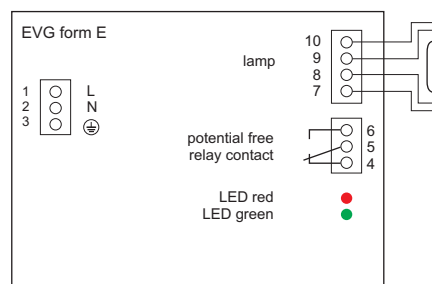



# ZED EVG - Electronic Ballasts 115V AC for Standard and High Output Germicidal Lamps and Amalgam Lamps Rapid Start

*established and proven:*  
**quick lamp start - easy handling**



ballast form F

**Features**

- ⇒ electronic ballast for two-lamp operation
  - ballasts are operating even with only one lamp connected
- ⇒ to be used with four-wire lamps
- ⇒ rapid start for applications with less than one switch-on cycle per day (otherwise preheat start ballasts are recommended)
- ⇒ equipped with active power factor correction
- ⇒ lamp status indication via LED indicators
  - green LED: lamp on
  - red LED: lamp fault
- ⇒ lamp status forwarding
  - potential free relay contacts for lamp on / lamp fault

ballast name	input power [W]	input current [A]	power per lamp [W]	lamp current [A]	lamp type
EVG2x[30-50W]/425mA -1	up to 110	0,5 - 1,05	30 - 50	0,39 - 0,42	G36T5, GPH793T5, LTC40T5, TUV36T5
EVG2x[50-70W]/425mA -1	up to 150	0,86 - 1,4	50 - 70	0,39 - 0,42	G64T5, LTC64T5, TUV64T5
EVG2x[50-70W]/600mA -1	up to 150	0,86 - 1,4	50 - 70	0,59 - 0,61	GPH846T5HO(600mA), GPH893T5HO(600mA)
EVG2x[50-70W]/670mA -1	up to 150	0,86 - 1,4	50 - 70	0,65 - 0,7	NNI60/25U
EVG2x[65-80W]/880mA -1	up to 170	1,1 - 1,6	65 - 80	0,85 - 0,9	GHO36T5, GPH846T5HO(800mA), GPH893T5HO(800mA), LTC75T8, LTC80T5, TUV36HO, TUV75

<b>mains voltage:</b>	115V AC ± 10%
<b>mains frequency:</b>	45...65Hz
<b>efficiency:</b>	> 88%
<b>t<sub>c</sub>-temperature:</b>	max. 50°C
<b>ambient temperature:</b>	0...40°C
<b>relay contacts:</b>	potential free, load: 50...500mA at 24...230V AC; 50...500mA at 5...60V DC
<b>status indication:</b>	operating status indicated - by LED: green = lamp on   red = lamp fault - by relay (refer to 'Ballast Generals' for more information on lamp status indication via relay)
<b>IP code:</b>	IP20
<b>mounting restrictions:</b>	upright, mains connector at bottom side, see 'Ballast Generals' for details
<b>wire gauge:</b>	terminals 1-3, 10-17: 0,75...1,5mm <sup>2</sup> strip length: 10...12mm terminals 4-9: 0,5...1mm <sup>2</sup> ; strip length: 8mm

**Dimensions**

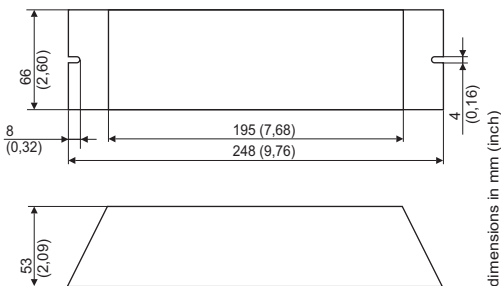

**Wiring diagram**

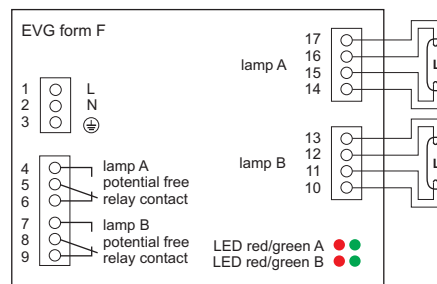



## ZED EVG - Electronic Ballasts 115V AC for Standard and High Output Germicidal Lamps and Amalgam Lamps Rapid Start

*established and proven:*  
**quick lamp start - easy handling**



ballast form H

### Features

- ⇨ electronic ballast for one-lamp operation
- ⇨ to be used with four-wire lamps
- ⇨ rapid start  
for applications with less than one switch-on cycle per day  
(otherwise preheat start ballasts are recommended)
- ⇨ equipped with active power factor correction
- ⇨ lamp status indication via LED indicators
  - green LED: lamp on
  - red LED: lamp fault
- ⇨ lamp status forwarding
  - potential free relay contacts for lamp on / lamp fault

ballast name	input power [W]	input current [A]	power per lamp [W]	lamp current [A]	lamp type
EVG150-200W/1,5A -1	160 – 220	1,26 - 2,1	150 - 200	1,4 - 1,5	GIA200, UNI201
EVG160-200W/2A -1	175 – 220	1,4 - 2,1	160 - 200	1,85 – 2	NNI200/107, NNI201/107XL, UNI200
EVG240W/2A -1	250 - 280	2,0 - 2,7	220 - 250	1,9 - 2,2	UNI260, GIA240, TUV240XPT
EVG300W/2,1A -1	350	2,76 - 3,38	320	2,1 - 2,4	NNI300/147XL

<b>mains voltage:</b>	115V AC $\pm$ 10%
<b>mains frequency:</b>	45...65Hz
<b>efficiency:</b>	> 88%
<b>t<sub>c</sub>-temperature:</b>	max. 50°C
<b>ambient temperature:</b>	0...40°C
<b>relay contacts:</b>	potential free, load: 50...500mA at 24...230V AC; 50...500mA at 5...60V DC
<b>status indication:</b>	operating status indicated - by LED: green = lamp on   red = lamp fault - by relay (refer to 'Ballast Generals' for more information on lamp status indication via relay)
<b>IP code:</b>	IP20
<b>mounting restrictions:</b>	upright, mains connector at bottom side, see 'Ballast Generals' for details
<b>wire gauge:</b>	0,75...1,5mm <sup>2</sup> ; strip length: 10...12mm

### Dimensions

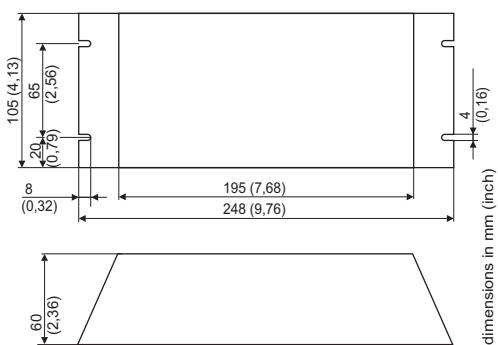

### Wiring diagram

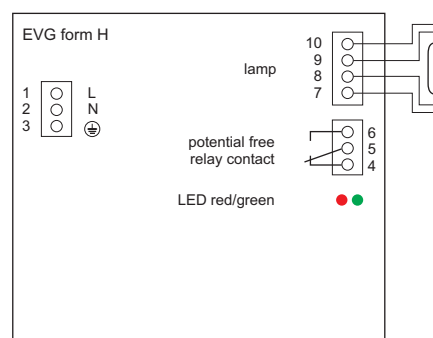



## ZED EVG - Electronic Ballasts 115V AC for Standard and High Output Germicidal Lamps and Amalgam Lamps Preheat Start

**lamp friendly:**  
soft lamp start allows more on-/off cycles



ballast form E-PH

### Features

- ⇒ electronic ballast for one-lamp operation
- ⇒ to be used with four-wire lamps
- ⇒ preheat start  
for applications with more than one switch-on cycle per day
  - preheat values are fixed
- ⇒ equipped with active power factor correction
- ⇒ lamp status indication via LED indicators
  - green LED: lamp on
  - red LED: lamp fault
- ⇒ lamp status forwarding
  - potential free relay contacts for lamp on / lamp fault

ballast name	input power [W]	input current [A]	power per lamp [W]	lamp current [A]	preheat current [A]	preheat time [s]	lamp type
EVG100-150W/1,5A -1 -PH	110 - 160	0,86 - 1,55	100 - 150	1,4 - 1,5	2	12	NNI80/36U, NNI120/86, NNI125/86

<b>mains voltage:</b>	115V AC $\pm$ 10%
<b>mains frequency:</b>	45...65Hz
<b>efficiency:</b>	> 88%
<b>t<sub>c</sub>-temperature:</b>	max. 50°C
<b>ambient temperature:</b>	0...40°C
<b>relay contacts:</b>	potential free, load: 50...500mA at 24...230V AC; 50...500mA at 5...60V DC
<b>status indication:</b>	operating status indicated - by LED: green = lamp on   red = lamp fault - by relay (refer to 'Ballast Generals' for more information on lamp status indication via relay)
<b>IP code:</b>	IP20
<b>mounting restrictions:</b>	upright, mains connector at bottom side, see 'Ballast Generals' for details
<b>wire gauge:</b>	0,75...1,5mm <sup>2</sup> ; strip length: 10...12mm

### Dimensions

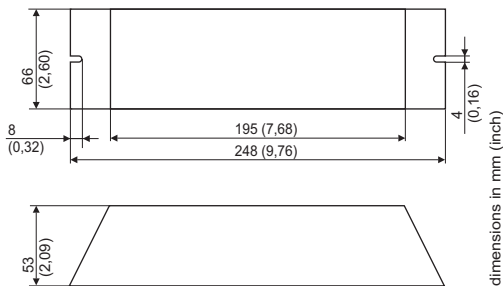

### Wiring diagram

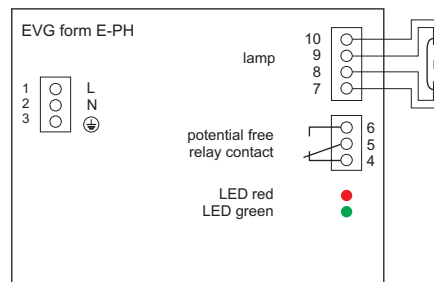



## ZED EVG - Electronic Ballasts 115V AC for Standard and High Output Germicidal Lamps and Amalgam Lamps Preheat Start

**lamp friendly:**  
soft lamp start allows more on-/off cycles



ballast form H-PH

### Features

- ⇒ electronic ballast for one-lamp operation
- ⇒ to be used with four-wire lamps
- ⇒ preheat start for applications with more than one switch-on cycle per day
  - preheat values are fixed
- ⇒ equipped with active power factor correction
- ⇒ lamp status indication via LED indicators
  - green LED: lamp on
  - green LED blinking: preheating
  - red LED: lamp fault
- ⇒ lamp status forwarding
  - potential free relay contacts for lamp on / lamp fault

ballast name	input power [W]	input current [A]	power per lamp [W]	lamp current [A]	preheat current [A]	preheat time [s]	lamp type
EVG160-200W/2A -1 -PH	175 – 220	1,4 - 2,1	160 - 200	1,85 – 2	2	12	NNI200/107, NNI201/107XL
EVG300W/2,1A -1 -PH	350	2,76 - 3,38	320	2,1 - 2,4	2	12	NNI300/147XL

<b>mains voltage:</b>	115V AC $\pm$ 10%
<b>mains frequency:</b>	45...65Hz
<b>efficiency:</b>	> 88%
<b>t<sub>c</sub>-temperature:</b>	max. 50°C
<b>ambient temperature:</b>	0...40°C
<b>relay contacts:</b>	potential free, load: 50...500mA at 24...230V AC; 50...500mA at 5...60V DC
<b>status indication:</b>	operating status indicated - by LED: green = lamp on   green blinking = preheating   red = lamp fault - by relay (refer to 'Ballast Generals' for more information on lamp status indication via relay)
<b>IP code:</b>	IP20
<b>mounting restrictions:</b>	upright, mains connector at bottom side, see 'Ballast Generals' for details
<b>wire gauge:</b>	0,75...1,5mm <sup>2</sup> ; strip length: 10...12mm

### Dimensions

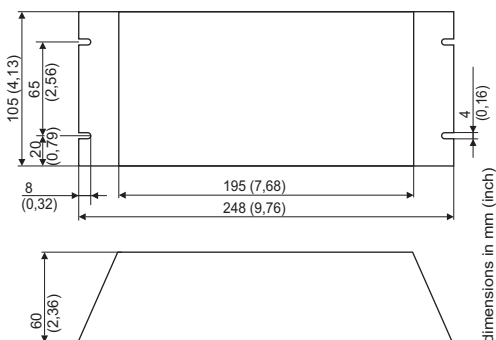

### Wiring diagram

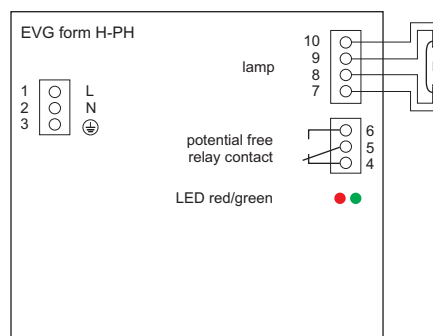



## ZED EVG - Electronic Ballasts 115V AC for Standard and High Output Germicidal Lamps and Amalgam Lamps Instant Start

**small but powerful:  
quick lamp start - economic wiring**



ballast form A-IS

### Features

- ⇒ electronic ballast for one-lamp operation
- ⇒ to be used with two-wire lamps
- ⇒ instant start  
for applications with less than one switch-on cycle per day  
(otherwise preheat start ballasts are recommended)
- ⇒ equipped with active power factor correction
- ⇒ lamp status indication via LED indicators
  - green LED: lamp on
  - red LED: lamp fault
- ⇒ lamp status forwarding
  - photocoupler for lamp on / lamp fault

ballast name	input power [W]	input current [A]	power per lamp [W]	lamp current [A]	lamp type
EVG11-20W/425mA IS -1	up to 24	0,11 - 0,23	11-20	0,425 ± 10%	TUV16, GPH287T5L, GPH303T5L, GPH436T5L

Lamp filament must be suitable for instant start operation, ask lamp manufacturer.

<b>mains voltage:</b>	115V AC ± 10%
<b>mains frequency:</b>	45...65Hz
<b>efficiency:</b>	approx. 85%
<b>t<sub>c</sub>-temperature:</b>	max. 50°C
<b>ambient temperature:</b>	0...40°C
<b>status indication:</b>	operating status indicated - by LED: green = lamp on   red = lamp fault - by photocoupler (refer to 'Ballast Generals' for more information on lamp status indication via photocoupler)
<b>connection specifics:</b>	terminals 1...4, max. off-load voltage: 1.5kV <sub>pp</sub> photocoupler, max. current on OG: 5mA (open collector V <sub>OG1/0</sub> < 1V ⇒ V <sub>CESAT</sub> < 1V) max. cable length between ballast and lamp: 0,5m
<b>IP code:</b>	IP20
<b>mounting restrictions:</b>	upright, mains connector at bottom side, see 'Ballast Generals' for details
<b>wire gauge:</b>	0,5...1mm <sup>2</sup> ; strip length: 8mm

### Dimensions

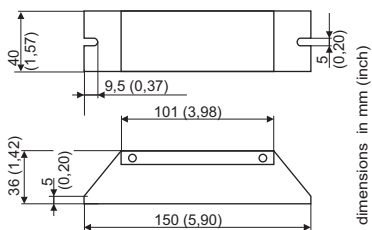

### Wiring diagram

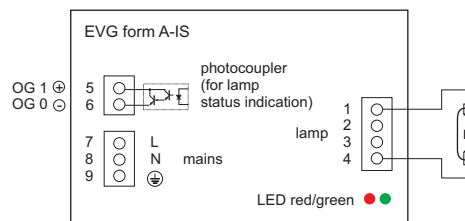



## ZED EVG - Electronic Ballasts 115V AC for Standard and High Output Germicidal Lamps and Amalgam Lamps Instant Start

*small and smart:*

*quick lamp start - economic wiring*



ballast form D-IS

### Features

- ⇒ electronic ballast for one-lamp operation
- ⇒ to be used with two-wire lamps
- ⇒ instant start  
for applications with less than one switch-on cycle per day  
(otherwise preheat start ballasts are recommended)
- ⇒ equipped with active power factor correction
- ⇒ lamp status indication via LED indicators
  - green LED: lamp on
  - red LED: lamp fault
- ⇒ lamp status forwarding
  - potential free relay contacts for lamp on / lamp fault

ballast name	input power [W]	input current [A]	power per lamp [W]	lamp current [A]	lamp type
S-EVG30-50W/425mA IS-1	32 - 55	0,25 - 0,53	30 - 50	0,39 - 0,42	G36T5, GPH793T5, LTC40T5, TUV36T5

Lamp filament must be suitable for this operation type, ask lamp manufacturer.

<b>mains voltage:</b>	115V AC $\pm$ 10%
<b>mains frequency:</b>	45...65Hz
<b>efficiency:</b>	> 88%
<b>t<sub>c</sub>-temperature:</b>	max. 50°C
<b>ambient temperature:</b>	0...40°C
<b>relay contacts:</b>	potential free, load: 50...500mA at 24...230V AC; 50...500mA at 5...60V DC
<b>status indication:</b>	operating status indicated - by LED: green = lamp on   red = lamp fault - by relay (refer to 'Ballast Generals' for more information on lamp status indication via relay)
<b>IP code:</b>	IP20
<b>mounting restrictions:</b>	upright, mains connector at bottom side, see 'Ballast Generals' for details
<b>wire gauge:</b>	0,5...1mm <sup>2</sup> ; strip length: 8mm

### Dimensions

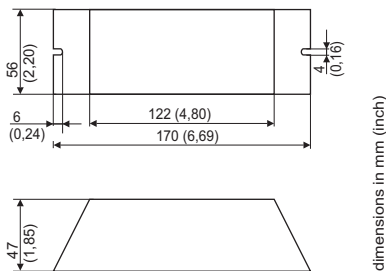

### Wiring diagram

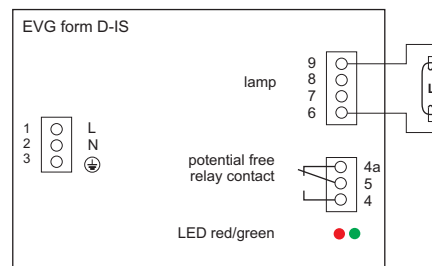



## ZED EVG - Electronic Ballasts 115V AC for Standard and High Output Germicidal Lamps and Amalgam Lamps Instant Start

*established and proven:*  
**quick lamp start - economic wiring**



ballast form E-IS

### Features

- ⇒ electronic ballast for one-lamp operation
- ⇒ to be used with two-wire lamps
- ⇒ instant start  
for applications with less than one switch-on cycle per day  
(otherwise preheat start ballasts are recommended)
- ⇒ equipped with active power factor correction
- ⇒ lamp status indication via LED indicators
  - green LED: lamp on
  - red LED: lamp fault
- ⇒ lamp status forwarding
  - potential free relay contacts for lamp on / lamp fault

ballast name	input power [W]	input current [A]	power per lamp [W]	lamp current [A]	lamp type
EVG50-70W/425mA IS-1	55 – 75	0,43 - 0,72	50 – 70	0,39 - 0,42	G64T5, LTC64T5, TUV64T5
EVG50-70W/600mA IS-1	55 – 75	0,43 - 0,72	50 – 70	0,59 - 0,61	GPH846T5HO(600mA), GPH893T5HO(600mA)
EVG65-80W/880mA IS-1	70 – 85	0,55 - 0,8	65 – 80	0,85 - 0,9	GHO36T5, GPH846T5HO(800mA), GPH893T5HO(800mA), LTC75T8, LTC80T5, TUV36HO
EVG150-200W/1A IS-1	160 – 220	1,26 - 2,1	150 -200	0,8 – 1	GHO64T5

Lamp filament must be suitable for instant start operation, ask lamp manufacturer.

<b>mains voltage:</b>	115V AC ± 10%
<b>mains frequency:</b>	45...65Hz
<b>efficiency:</b>	> 88%
<b>t<sub>c</sub>-temperature:</b>	max. 50°C
<b>ambient temperature:</b>	0...40°C
<b>relay contacts:</b>	potential free, load: 50...500mA at 24...230V AC; 50...500mA at 5...60V DC
<b>status indication:</b>	operating status indicated - by LED: green = lamp on   red = lamp fault - by relay (refer to 'Ballast Generals' for more information on lamp status indication via relay)
<b>IP code:</b>	IP20
<b>mounting restrictions:</b>	upright, mains connector at bottom side, see 'Ballast Generals' for details
<b>wire gauge:</b>	0,75...1,5mm <sup>2</sup> ; strip length: 10...12mm

### Dimensions

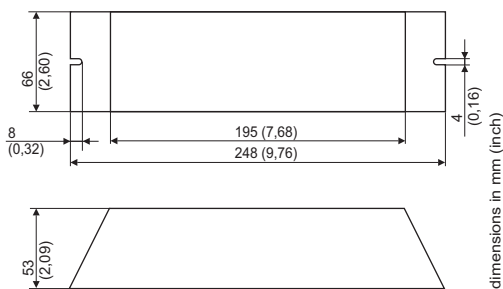

### Wiring diagram

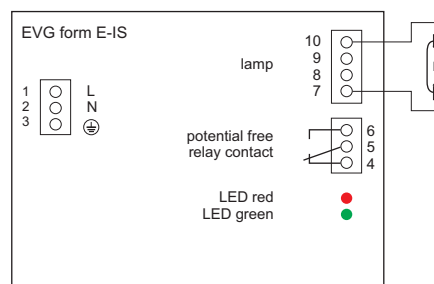



## ZED EVG - Electronic Ballasts 115V AC for Standard and High Output Germicidal Lamps and Amalgam Lamps Instant Start

*established and proven:*  
**quick lamp start - economic wiring**



ballast form F-IS

### Features

- ⇒ electronic ballast for two-lamp operation
  - ballasts are operating even with only one lamp connected
- ⇒ to be used with two-wire lamps
- ⇒ instant start  
for applications with less than one switch-on cycle per day (otherwise preheat start ballasts are recommended)
- ⇒ equipped with active power factor correction
- ⇒ lamp status indication via LED indicators
  - green LED: lamp on
  - red LED: lamp fault
- ⇒ lamp status forwarding
  - potential free relay contacts for lamp on / lamp fault

ballast name	input power [W]	input current [A]	power per lamp [W]	lamp current [A]	lamp type
EVG2x[30–50W]/425mA IS-1	up to 110	0,5 - 1,05	30 – 50	0,39 – 0,42	G36T5, GPH793T5, LTC40T5, TUV36T5
EVG2x[50–70W]/425mA IS-1	up to 150	0,86 - 1,4	50 – 70	0,39 – 0,42	G64T5, LTC64T5, TUV64T5
EVG2x[50–70W]/600mA IS-1	up to 150	0,86 - 1,4	50 – 70	0,59 – 0,61	GPH846T5HO(600mA), GPH893T5HO(600mA)
EVG2x[65–80W]/880mA IS-1	up to 170	1,1 - 1,6	65 – 80	0,85 – 0,9	GHO36T5, GPH846T5HO(800mA), GPH893T5HO(800mA), LTC75T8, LTC80T5, TUV36HO

Lamp filament must be suitable for instant start operation, ask lamp manufacturer.

<b>mains voltage:</b>	115V AC ± 10%
<b>mains frequency:</b>	45...65Hz
<b>efficiency:</b>	> 88%
<b>t<sub>c</sub>-temperature:</b>	max. 50°C
<b>ambient temperature:</b>	0...40°C
<b>relay contacts:</b>	potential free, load: 50...500mA at 24...230V AC; 50...500mA at 5...60V DC
<b>status indication:</b>	operating status indicated - by LED: green = lamp on   red = lamp fault - by relay (refer to 'Ballast Generals' for more information on lamp status indication via relay)
<b>IP code:</b>	IP20
<b>mounting restrictions:</b>	upright, mains connector at bottom side, see 'Ballast Generals' for details
<b>wire gauge:</b>	terminals 1-3, 10-17: 0,75...1,5mm <sup>2</sup> strip length: 10...12mm terminals 4-9: 0,5...1mm <sup>2</sup> ; strip length: 8mm

### Dimensions

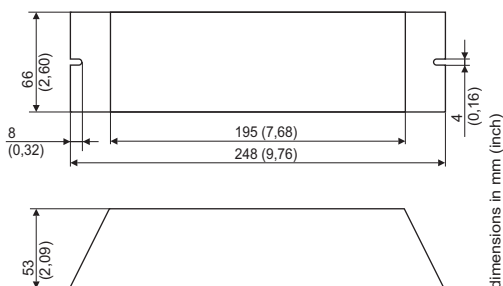

### Wiring diagram

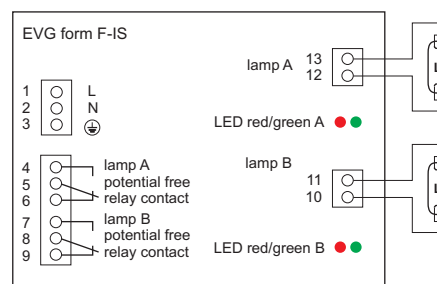



---

## Notices

---